

#### Special Features :

- Diaphragm directly welded to top chamber
- Easy to clean
- Easy to change process connection / bottom chamber

#### Applications :

- Diaphragm seals are provided in the instruments like pressure gauges, switches, transmitters in order to isolate the sensing element from the main service due to its corrosive, viscous and sedimented nature and to avoid clogging and solidification
- These kind of seals are widely used in the viscous & corrosive services where flushing is required periodically & frequently



#### Specifications

##### STANDARD VERSION

Range	: S01 = -1 to 0 kg/cm <sup>2</sup> & 0 to 70 kg/cm <sup>2</sup> (Standard Version)
	: S02 = -1 to 0 kg/cm <sup>2</sup> & 0 to 70 kg/cm <sup>2</sup> (Extended Neck Type)
Process temperature	: - 40°C to 200°C or as per fill fluid
Instruments connection	: ½" BSP (F)
Process connection	: ½" BSP (M)
Filling fluid	: Silicon oil - DC 200
Mounting	: Direct (without capillary)

Diaphragm	: AISI 316L SS
Top chamber	: AISI 304 SS
Bottom chamber	: AISI 316 SS
Nuts / bolts	: Steel(plated)
Sealing gasket	: PTFE
Tension flange (cup type)	: Steel (Black powder coated)

#### DIMENSIONS

TYPE "S01"

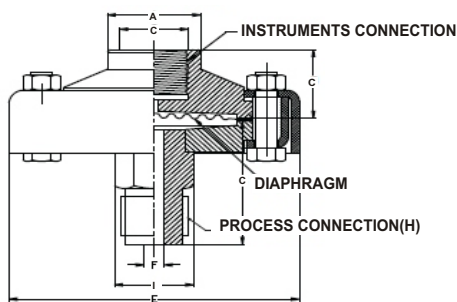

Size	A	~B	~C	E	F	G	H	I
63	30	27	45	93	6	½" BSP (F)	½" BSP (M)	HEX A/F22

TYPE "S02"

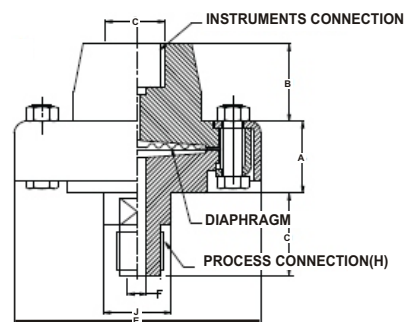

Size	A	~B	~C	E	F	G	H	J
63	27	29	32	93	6	½" BSP (F)	½" BSP (M)	25

Note: Drawings are not to scale. All Dimensions are in mm.

# SELECTION OF MODEL

## (1) MODEL CODE

### (2) SEAL TYPE

-1 to 0 & 0 to 70 Kg/Cm <sup>2</sup> (Standard)	S01
-1 to 0 & 0 to 70 Kg/Cm <sup>2</sup> (Extended Neck type)	S12

### (3) INSTRUMENT CONNECTION

1/4" BSP (F)	2BF	1/2" NPT(F)	4NF
1/2" BSP (F) (STD)	4BF	1/4" BSP(F)	2NF
3/8" BSP (F)	2BF		

### (4) DIAPHRAGM

HASTALLOY 'C'	HT	SILVER	SR
AISI 316L SS	S6L	TITANIUM	TI
INCONEL 600	IN	TANTALUM	TA
MONEL	MN		

### (5) TOP CHAMBER

AISI 316 SS (STD)	S6
AISI 316L SS	S6L
AISI 304 SS	S4

### (6) BOTTOM CHAMBER

AISI 316 SS (STD)	S6	AISI 304	S4
AISI 316L SS	S6L	TITANIUM	TI
Hastelloy 'C'	HC	TANTALUM	TA
Monel	MN		

### (7) PROCESS CONNECTION

(\* For Dry Seal Type: S14)

1/4" NPT(M)	2NM	3/8" BSP(M)	3BM
1/2" NPT(M) (STD)*	4NMM	1/2" BSP(M) (STD)	4BM
3/4" NPT (M)	5NM	3/4" BSP(M)	5BM
M20 x 1.5 (M)	1MM		

Note : Other Connections like Metric / PT / PF / G / R etc can be provided on request.

### (8) TENSION FLANGE & NUT -BOLT (\* Nut & Bolts will be AISI 304 SS)

Steel-Plated (Cup Type)	TS	AISI 316	T6
AISI 304 SS	T4		

### (9) FILLING FLUIDS

Fluorolube 4.2 (-45 to 175°C)	01	Silicon DC 704 (10 to 337°)	06
Fluorolube 6.3 (-40 to 235°C)	02	Silicon DC 710 (7 to 3717°)	07
Fluorolube FS-5 (-28 to 148°C)	03	Syltherm 800 (-40 to 315°C)	08
Food Grade Oil (-20 to 140°C)	04	Syltherm XLT (-100 to 260°C)	09
Silicon DC 200 (-40 to 2050°C)	05	Halocarbon Oil	10

### (10) REMOTE MOUNTING(with capillary of Max. Up to 3 Mtrs.)

SPECIFY IN METERS ( e.g.1.5 =1.5 Meters 2.0 = 2 Meters )

### (11) CAPILLARY

AISI 304 SS	S4
AISI 316 SS	S6

CSO

S01

4BF

S6L

S4

S6

4BM

TS

05

1.5Mtr

S4

# SELECTION OF MODEL

## (12) CAPILLARY COVERED WITH ARMOUR (Applicable with S01 or S02 is selected)

AISI 304 SS	S4
AISI 316 SS	S6
PVC(ambient Temp. Max. 60° C)	PC

## (13) OPTIONS

HELIUM LEAK TEST	HT
DRY SEAL ONLY WITHOUT INSTRUMENT	SD
MATERIAL TEST CERTIFICATES	MC

Example	1	2	3	4	5	6	7	8	9
SELECTION OF MODEL	CSO	S01	4BF	S6L	S4	S6	4BM	TS	05

Example	10	11	12	13
SELECTION OF MODEL	1.5Mtr	S4	XX	XX

Note: Material Test Certificates will be provided for wetted parts only with Chemical Composition Testing. For Others, Consult Factory.

XX

XX

## NESSTECH INC.

### INTERNATIONAL SALES DEPARTMENT

1-12-1 Akanehama, Narashino-shi, Chiba  
275-0024, JAPAN

PHONE +81-47-453-1182

F A X +81-47-453-0727

## NESSTECH INSTRUMENTS PVT. LTD (INDIA)

Survey No. 26/2, "G" Type, Global Industrial Park,  
Near Nahuli Railwaycrossing, Village Valvada, Vapi,  
Tal Umbergaon, Dist Valsad-396191, Gujrat  
TEL: +91-260-299-6920

## NESS TECHNOLOGY (M) SDN BHD (MALAYSIA)

No. 42A Jalan PUJ 3/8, Taman Puncak Jalil, Bandar Putra Permai,  
43300 Seri Kembangan, Selangor  
TEL: +603-8940-1134/8940-1059 FAX: +603-8999-4133